

## Replacement Parts List for Model # 725

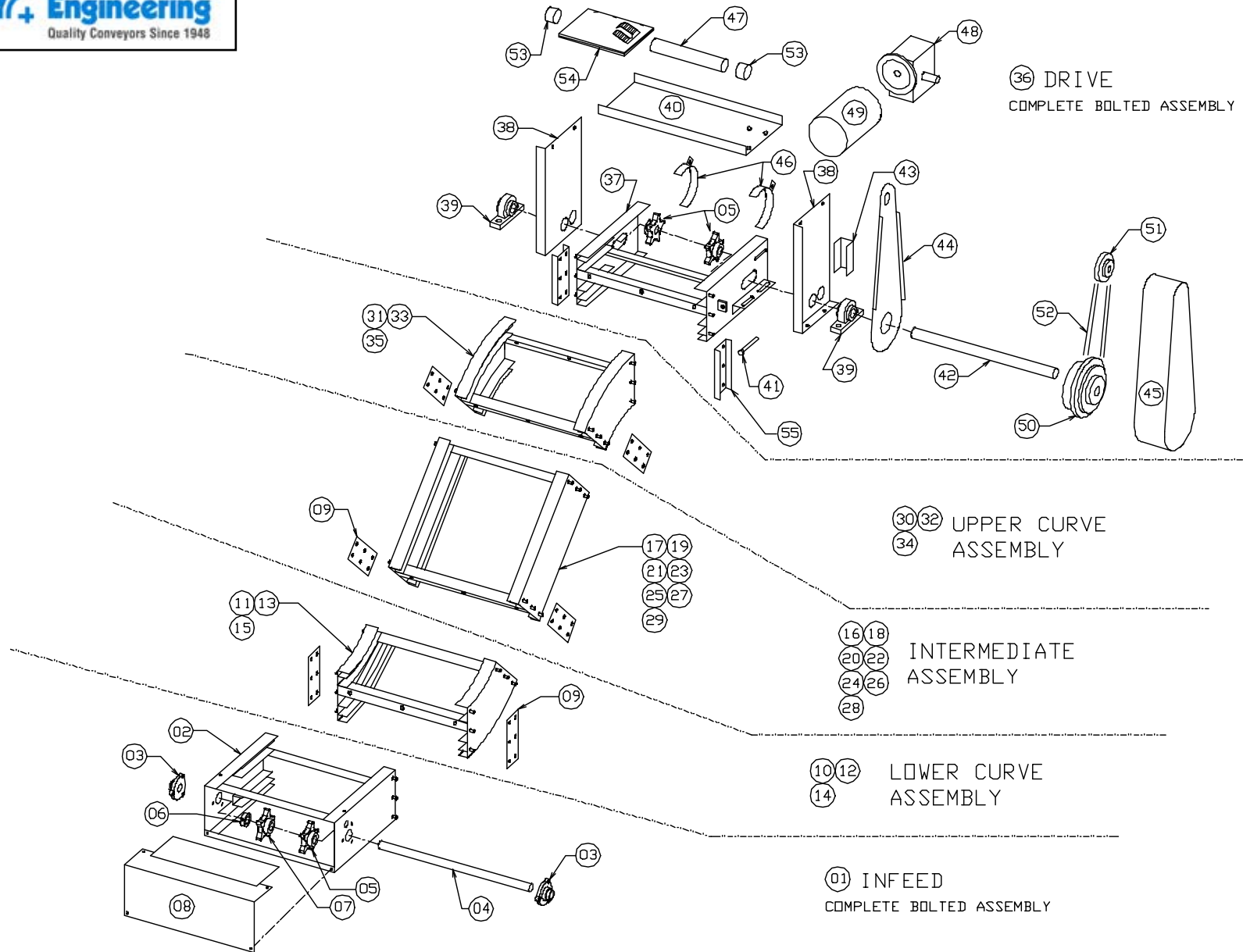

See next page for part numbers and descriptions



## Replacement Parts List for Model # 725

### PN Description

- |    |                                 |    |                                |
|----|---------------------------------|----|--------------------------------|
| 1  | Infeed Section Assembly         | 29 | 120" Intermediate Weldment     |
| 2  | Infeed Frame Weldment           | 30 | 30° Upper Curve Assembly       |
| 3  | • 1 3/16" 3 Bolt Flange Bearing | 31 | 30° Upper Curve Weldment       |
| 4  | • Infeed Shaft (1 3/16" Dia)    | 32 | 45° Upper Curve Assembly       |
| 5  | • Fixed, Infeed/ Drive Sprocket | 33 | 45° Upper Curve Weldment       |
| 6  | • Locking Collar                | 34 | 60° Upper Curve Assembly       |
| 7  | • Floater, Infeed Sprocket      | 35 | 60° Upper Curve Weldment       |
| 8  | Infeed Guard Assembly           | 36 | Drive Section Assembly         |
| 9  | Splice Plate                    | 37 | Drive Section Weldment         |
| 10 | 30° Lower Curve Assembly        | 38 | Drive Plate Weldment           |
| 11 | 30° Lower Curve Weldment        | 39 | • 1 3/16" Pillow Block Bearing |
| 12 | 45° Lower Curve Assembly        | 40 | Motor Base                     |
| 13 | 45° Lower Curve Weldment        | 41 | Take-up Bolt                   |
| 14 | 60° Lower Curve Assembly        | 42 | • Drive Shaft (1 7/16" Dia)    |
| 15 | 60° Lower Curve Weldment        | 43 | • Drive Guard Bracket          |
| 16 | 6" Intermediate Assembly        | 44 | Drive Guard Back               |
| 17 | 6" Intermediate Weldment        | 45 | Guard Weldment                 |
| 18 | 12" Intermediate Assembly       | 46 | Sprocket Guard                 |
| 19 | 12" Intermediate Weldment       | 47 | Manual Tube                    |
| 20 | 18" Intermediate Assembly       | 48 | • Reducer                      |
| 21 | 18" Intermediate Weldment       | 49 | • Motor                        |
| 22 | 24" Intermediate Assembly       | 50 | • Torque Limiter               |
| 23 | 24" Intermediate Weldment       | 51 | • Reducer Sprocket             |
| 24 | 48" Intermediate Assembly       | 52 | • Chain                        |
| 25 | 48" Intermediate Weldment       | 53 | • Manual Tube Cap              |
| 26 | 84" Intermediate Assembly       | 54 | Manual                         |
| 27 | 84" Intermediate Weldment       | 55 | Support Splice Plate           |
| 28 | 120" Intermediate Assembly      |    |                                |

- **Recommended spare parts to be stocked at your location**